

EHV BUS COUPLERS

ALUMINUM • 345 - 500 KV

TYPE ASCTHV Bolted Coupler For Pipe

Castings: 356-T6 Aluminum
Clamping Hardware: Aluminum Alloy

Type ASCTHV is designed for corona-free service within the voltage limitations of the tubular conductor size. Separate caps provide independent clamping action for each member.

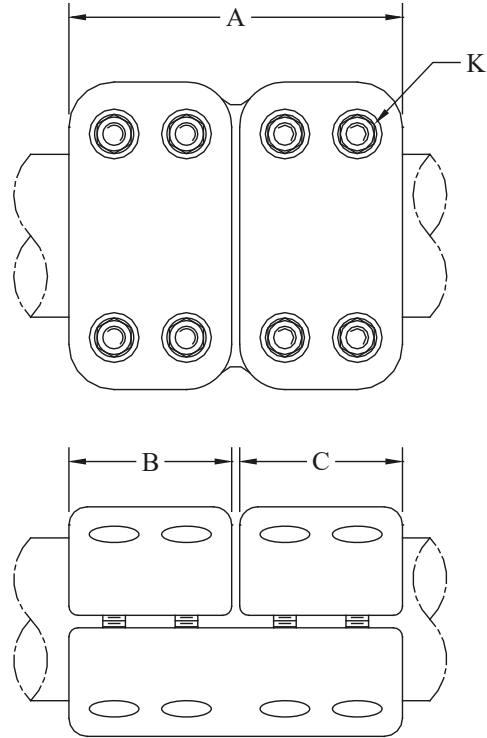
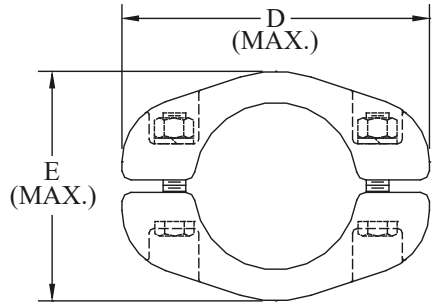

CATALOG NUMBER	PIPE SIZE (NPS)		MAX. KV	DIMENSIONS - INCHES					
	MAIN	TAP		A	B	C	D	E	K
ASCTHV-5858	2	2	345	12-3/4	4	4	5-1/2	3-1/2	1/2
ASCTHV-6058	2-1/2	2	345	13-1/2	4-1/2	4	7-1/4	5-1/4	1/2
ASCTHV-6060		1-1/2	345	9-1/4	4-1/2	4-1/2	7-1/2	5-1/4	5/8
ASCTHV-6258	3	2	345	8	4	3-3/4	7	5	1/2
ASCTHV-6260		2-1/2	345	8-3/4	4-1/2	4	7-1/2	5-1/4	5/8
ASCTHV-6262		3	500	9-1/4	4-1/2	4-1/2	7-1/2	5-1/4	5/8
ASCTHV-6360	3-1/2	2-1/2	345	8-3/4	4-1/2	4	7-1/8	5-1/4	5/8
ASCTHV-6362		3	500	14-5/8	4-1/2	5	7-1/8	5-1/2	5/8
ASCTHV-6363		3-1/2	500	9-1/4	4-1/2	4-1/2	8	5-1/8	5/8
ASCTHV-6462	4	3	500	14-5/8	4-1/2	4-1/2	8-1/2	6-1/4	5/8
ASCTHV-6463		3-1/2	500	14-3/4	4-1/2	5	8-1/2	6-1/4	5/8
ASCTHV-6464		4	500	9-1/4	4-1/2	4-1/2	8-1/2	6-3/8	5/8
ASCTHV-6762	5	3	500	9-1/2	4-3/4	4-1/2	8-3/4	6-3/4	5/8
ASCTHV-6764		4	500	9-1/2	4-3/4	4-1/2	10	6-3/4	5/8
*ASCTHV-6767		5	500	16-3/4	7	7	9-1/2	7-1/8	5/8
ASCTHV-6962	6	3	500	17-1/4	7	4-1/2	9-7/8	8-3/4	5/8
ASCTHV-6964		4	500	17-3/8	7	4-1/2	9-7/8	8-3/4	5/8
*ASCTHV-6969		6	500	14-3/8	7	7	9-7/8	8-3/4	5/8

*12 Clamping Bolts