

ALUMINUM COUPLERS

TYPE ALB90

90° Angle Bolted
Pipe Main to Pipe Tap

Aluminum alloy angle coupler for aluminum pipe connections at 90°. Clamping bolts have hex-stops for one wrench installation. Contact sealant is recommended.

Castings: 356-T6 Aluminum
Hardware: Aluminum Alloy

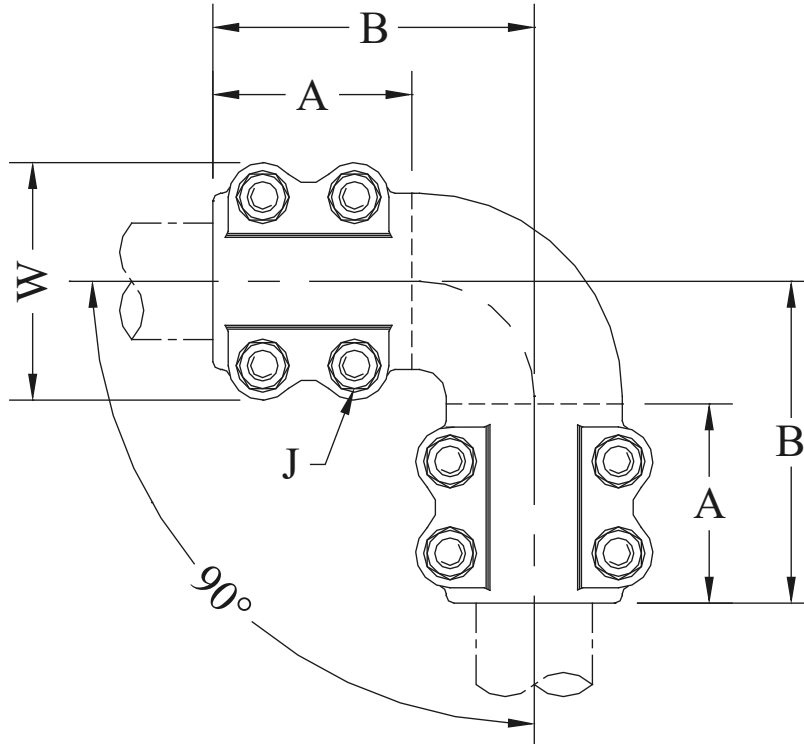

| CATALOG NUMBER | CONDUCTOR SIZE (NPS) | | DIMENSIONS - INCHES | | | | WEIGHT (POUNDS) |
|----------------|----------------------|----------|---------------------|---------|-------|-----|-----------------|
| | PIPE MAIN | PIPE TAP | A | B | W | J | |
| ALB90-3030 | 3/4 | 3/4 | 2-1/2 | 3-15/16 | 3 | 1/2 | 1.80 |
| ALB90-3939 | 1 | 1 | 2-3/4 | 4-7/8 | 3-1/4 | 1/2 | 2.20 |
| ALB90-4949 | 1-1/4 | 1-1/4 | 3 | 4-3/4 | 3-5/8 | 1/2 | 3.60 |
| ALB90-5353 | 1-1/2 | 1-1/2 | 3-5/16 | 5 | 3-7/8 | 1/2 | 4.50 |
| ALB90-5858 | 2 | 2 | 3-9/16 | 5-1/2 | 4-3/8 | 1/2 | 5.60 |
| ALB90-6060 | 2-1/2 | 2-1/2 | 3-5/8 | 6-1/4 | 4-3/4 | 1/2 | 8.40 |
| ALB90-6262 | 3 | 3 | 4-1/8 | 6-3/8 | 5-7/8 | 5/8 | 10.70 |
| ALB90-6363 | 3-1/2 | 3-1/2 | 4-3/8 | 6-7/8 | 6-3/8 | 5/8 | 12.00 |
| ALB90-6464 | 4 | 4 | 4-1/4 | 7-15/16 | 7 | 5/8 | 16.00 |
| ALB90-6767 | 5 | 5 | 5 | 9 | 8 | 5/8 | 18.00 |