

ALUMINUM BUS SUPPORTS

TYPE ACSTI

Horizontal Bolted
Pipe to Insulator
(Coupler)

Aluminum alloy bus support sliding coupler for aluminum pipe.
Clamping bolts have hex-stops for one-wrench installation.

Hardware supplied for CAP mounting.
For PIN mounting, add suffix (P) to catalog number.

Example: ACSTI-60-5P

Castings: 356-T6 Aluminum

Clamping Hardware: Aluminum Alloy

Mounting Hardware: Galvanized Steel

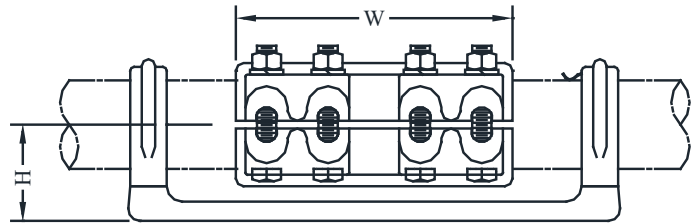
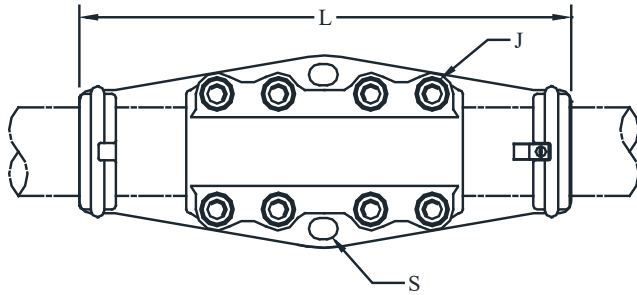

CATALOG NUMBER	PIPE SIZE (NPS)	BOLT CIRCLE	DIMENSIONS - INCHES					WEIGHT (POUNDS)
			H	L	W	S	J	
ACSTI-58-3	2	3	2-3/4	12-3/4	7-1/2	9/16 x 3/4	1/2	9.60
ACSTI-58-5		5	2-3/4	16	9-1/4	11/16 x 1	1/2	10.40
ACSTI-60-3	2-1/2	3	3-1/8	17-1/2	9	9/16 x 13/16	1/2	13.30
ACSTI-60-5		5	3-1/8	16	9	11/16 x 1-1/16	5/8	14.10
ACSTI-62-3	3	3	3-5/8	17-1/2	10-1/8	9/16 x 13/16	5/8	15.70
ACSTI-62-5		5	3-5/8	17-1/2	10-1/8	11/16 x 15/16	5/8	17.30
ACSTI-63-3	3-1/2	3	4	16	11	9/16 x 13/16	5/8	16.50
ACSTI-63-5		5	4	16	11	11/16 x 1-1/16	5/8	16.90
ACSTI-64-3	4	3	4-1/2	17-1/2	12	9/16 x 13/16	5/8	23.70
ACSTI-64-5		5	4-1/2	16	12	11/16 x 1-1/16	5/8	24.50
ACSTI-67-3	5	3	5	19-5/8	13-1/2	9/16 x 13/16	5/8	26.30
ACSTI-67-5		5	5	19-5/8	13-1/2	11/16 x 1-1/16	5/8	26.30
ACSTI-69-3	6	3	5-1/2	19-5/8	12-3/4	9/16 x 13/16	5/8	25.50
ACSTI-69-5		5	5-1/2	19-5/8	12-3/4	11/16 x 1-1/16	5/8	25.50