

# ALUMINUM TERMINALS

## TYPE WSFFT90

Weldment Expansion  
Pipe to Flat

Aluminum semi-flexible terminal for connecting aluminum pipe to flat. Aluminum pad surface is coated with contact sealant and factory-bolted to laminated strap. Flat pad on laminated strap has NEMA drilling. Contact sealant is recommended. NOTE: This connector is not recommended as a support member.

Castings: 356-T6 Aluminum  
Laminated Straps: Copper  
(Contact Pads Tin Plated)  
Strap Mounting Hardware: Stainless Steel  
Options: See Page 211

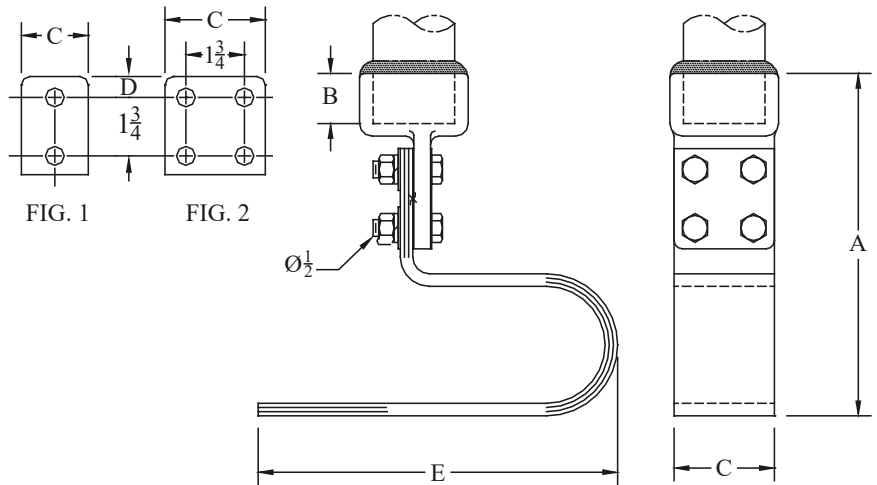

CATALOG NUMBER	FIG. NO.	PIPE SIZE (NPS)	DIMENSIONS - INCHES					WEIGHT (POUNDS)
			A	B	C	D	E	
WSFFT90-30-2B	1	3/4	9	15/16	2	5/8	10	3.85
WSFFT90-30-4A	2		9	15/16	3	5/8	10	4.15
WSFFT90-39-2B	1	1	10-3/4	2-1/2	2	5/8	10-5/8	4.45
WSFFT90-39-4A	2		9	15/16	3	5/8	10-1/4	4.75
WSFFT90-49-2B	1	1-1/4	9-3/4	1	2	5/8	10-1/4	5.75
WSFFT90-49-4A	2		9-3/4	1	3	5/8	10-1/4	6.25
WSFFT90-53-2B	1	1-1/2	10	1-3/8	2	5/8	10-3/8	6.50
WSFFT90-53-4A	2		10-1/8	1-3/8	3	5/8	10-3/4	10.10
WSFFT90-53-4B	2		10-7/8	1-3/8	4	1-1/8	12-7/8	14.85
WSFFT90-58-2B	1	2	10-3/16	1-1/2	2	5/8	11-3/16	8.25
WSFFT90-58-4A	2		10-1/4	1-1/2	3	5/8	10-3/4	10.40
WSFFT90-58-4B	2		11	1-1/2	4	1-1/8	12-7/8	15.10
WSFFT90-60-2B	1	2-1/2	10-1/2	1-1/2	2	5/8	11-7/16	9.15
WSFFT90-60-4A	2		10-1/2	1-1/2	3	5/8	10-5/8	13.95
WSFFT90-60-4B	2		11	1-1/2	4	1-1/8	12-7/8	15.60
WSFFT90-62-2B	1	3	9-5/8	1-3/4	2	5/8	12-7/8	9.75
WSFFT90-62-4A	2		11	1-3/4	3	5/8	10-7/8	15.00
WSFFT90-62-4B	2		12-1/4	1-3/4	4	1-1/8	12-3/4	24.10
WSFFT90-63-4A	2	3-1/2	11-1/2	1-7/8	3	5/8	12-1/2	20.65
WSFFT90-63-4B	2		12-3/8	1-7/8	4	1-1/8	12-3/4	25.00
WSFFT90-64-4A	2	4	11-5/8	2	3	5/8	12-1/2	21.65
WSFFT90-64-4B	2		12-1/4	2	4	1-1/8	12-3/4	24.80
WSFFT90-67-4B	2	5	14-1/8	2-7/8	4	1-1/8	13-1/16	15.75