

ALUMINUM TERMINALS

TYPE WFTOC

Weldment
Pipe to Flat

Castings: 356-T6 Aluminum
Options: See Page 211

Aluminum alloy weldment terminal for connecting aluminum pipe to flat pad. Center-formed tongues have NEMA drilling. Contact sealant is recommended for contact pad after welding.

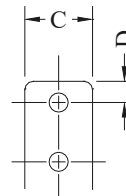

FIG. 1

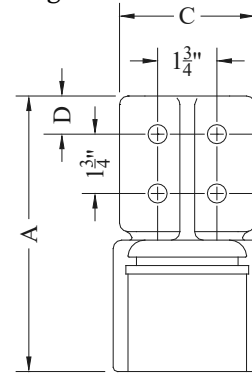
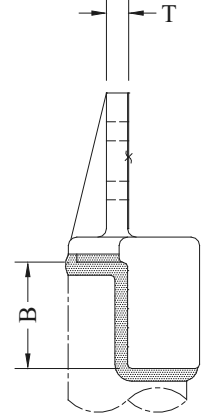

FIG. 2



CATALOG NUMBER	FIG. NO.	PIPE SIZE (NPS)	DIMENSIONS - INCHES					WEIGHT (POUNDS)
			A	B	C	D	T	
WFTOC-30-2B	1	3/4	6-1/8	2-1/2	2	5/8	3/8	0.50
WFTOC-30-4A	2		6-1/4	2-1/2	3	5/8	3/8	0.60
WFTOC-30-4B	2		7-1/4	2-1/2	4	1-1/8	3/8	0.85
WFTOC-39-2B	1	1	6-1/8	2-1/2	2	5/8	3/8	0.50
WFTOC-39-4A	2		6-1/4	2-1/2	3	5/8	3/8	0.75
WFTOC-39-4B	2		7-1/4	2-1/2	4	1-1/8	3/8	0.85
WFTOC-49-2B	1	1-1/4	6-5/8	2-3/4	2	5/8	3/8	0.70
WFTOC-49-4A	2		6-3/4	2-3/4	3	5/8	3/8	0.90
WFTOC-49-4B	2		7-3/4	2-3/4	4	1-1/8	3/8	1.15
WFTOC-53-2B	1	1-1/2	6-9/16	2-3/4	2	5/8	7/16	1.00
WFTOC-53-4A	2		6-9/16	2-3/4	3	5/8	7/16	1.00
WFTOC-53-4B	2		7-3/4	2-3/4	4	1-1/8	1/2	1.91
WFTOC-58-2B	1	2	7-3/8	3-1/4	2	5/8	1/2	1.25
WFTOC-58-4A	2		7-3/8	3-1/4	3	5/8	1/2	1.50
WFTOC-58-4B	2		8-1/4	3-1/4	4	1-1/8	1/2	1.75
WFTOC-60-2B	1	2-1/2	7-3/8	3-1/2	2	5/8	1/2	1.50
WFTOC-60-4A	2		7-1/2	3-1/2	3	5/8	1/2	1.75
WFTOC-60-4B	2		8-1/2	3-1/2	4	1-1/8	1/2	2.25
WFTOC-62-2B	1	3	7-1/8	3-1/8	2	5/8	5/8	2.50
WFTOC-62-4A	2		7-1/8	3-1/8	3	5/8	5/8	2.50
WFTOC-62-4B	2		8-3/16	3-1/8	4	1-1/8	5/8	2.65
WFTOC-63-2B	1	3-1/2	7-3/4	3-1/2	2	5/8	11/16	3.25
WFTOC-63-4A	2		7-3/4	3-1/2	3	5/8	11/16	3.25
WFTOC-63-4B	2		8-3/4	3-1/2	4	1-1/8	11/16	3.75
WFTOC-64-2B	1	4	7-1/2	3-1/4	2	5/8	3/4	4.00
WFTOC-64-4A	2		7-1/2	3-1/4	3	5/8	3/4	3.50
WFTOC-64-4B	2		8-1/2	3-1/4	4	1-1/8	3/4	4.00
WFTOC-67-4A	2	5	7-1/4	3	3	5/8	3/4	5.00
WFTOC-67-4B	2		8-3/8	3	4	1-1/8	3/4	5.00
WFTOC-69-4B	2	6	9-1/8	4	4	1-1/8	7/8	6.75