

BRONZE BUS SUPPORTS

TYPE SCRI

Horizontal Bolted
Cable to Insulator

Bronze alloy bus support for copper cable.

Hardware supplied for CAP mounting. For PIN mounting, add suffix (P) to catalog number.

Example: SCRI-20-5P

Castings: Electrical Bronze

Clamping Hardware: Silicon Bronze

Mounting Hardware: Galvanized Steel

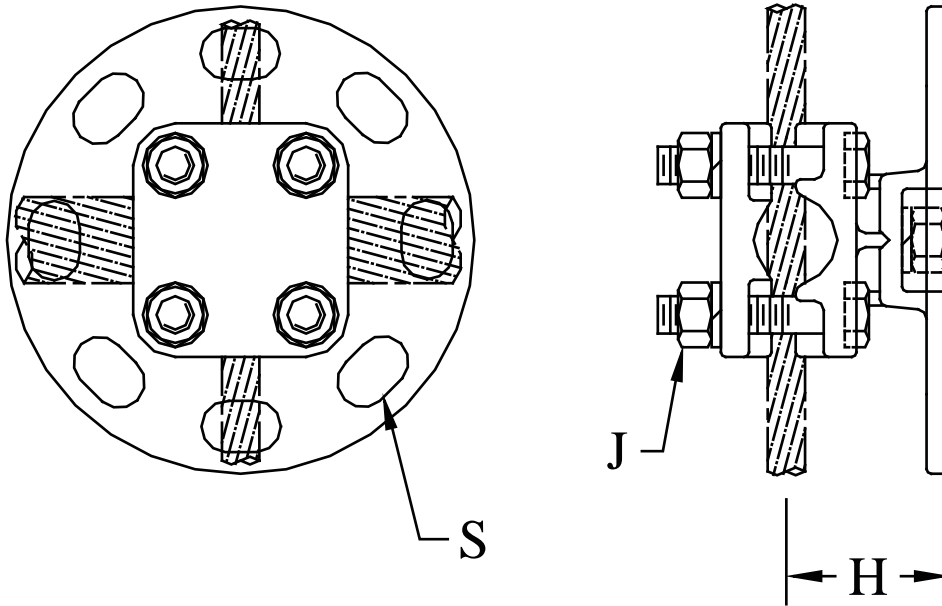

CATALOG NUMBER	CONDUCTOR RANGE	B.C.	DIMENSIONS-INCHES				WEIGHT (POUNDS)
			H	L	J	S	
SCRI-20-3	#6W-750 MCM	3	2	2-1/2	3/8	9/16 x 13/16	4.00
SCRI-20-5		5	2	2-1/2	3/8	11/16 x 1-1/16	5.25
SCRI-34-3	4/0W-1000 MCM	3	2-1/8	3-1/8	1/2	9/16 x 13/16	5.00
SCRI-34-5		5	2-1/8	3-1/8	1/2	11/16 x 1-1/16	6.25
SCRI-48-3	750-2000 MCM	3	2-1/2	3-1/2	1/2	9/16 x 13/16	5.50
SCRI-48-5		5	2-1/2	3-1/2	1/2	11/16 x 1-1/16	6.75