

# BRONZE MISCELLANEOUS

## TYPE DP-BR

Drive On - Internal  
End Plug

Internal bronze end plug for enclosing NPS SCH 40 or SCH 80 pipe ends.  
Plug is designed for drive-in fit with tapered internal fingers.  
Add (H) to conductor code for SCH 80 pipe. Example: DP-39H-BR.

Casting: Electrical Bronze

CATALOG NUMBER		CONDUCTOR SIZE (NPS)	THICKNESS (INCHES) T	WEIGHT (POUNDS)
NPS SCH 40	NPS SCH 80			
DP-39-BR	DP-39H-BR	1	3/8	0.62
DP-49-BR	DP-49H-BR	1-1/4	3/8	0.92
DP-53-BR	DP-53H-BR	1-1/2	7/16	0.75
DP-58-BR	DP-58H-BR	2	1/2	0.90
DP-60-BR	DP-60H-BR	2-1/2	5/8	1.625
DP-62-BR	DP-62H-BR	3	13/16	3.25
DP-63-BR	DP-63H-BR	3-1/2	13/16	4.00
DP-64-BR	DP-64H-BR	4	7/8	3.25
DP-67-BR	DP-67H-BR	5	1-1/4	6.90
DP-69-BR	DP-69H-BR	6	1-1/2	8.125

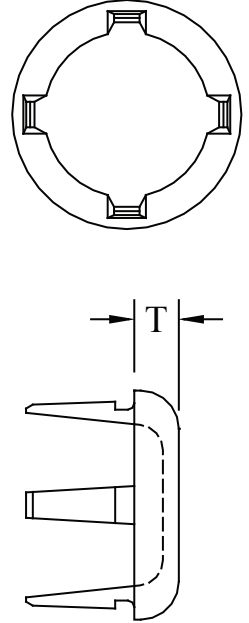

## TYPE DPS-BR

Drive On - Internal  
End Plug

Internal aluminum end plug for reducing electrostatic loss and enclosing NPS SCH 40 or SCH 80 pipe ends.

Compared to the DP series, the exposed portion of the DPS series is reduced for use with expansion bus supports and bolted terminals. The end cap is designed for a drive-in fit with tapered internal fingers. Consult manufacturer for further details or unlisted applications. Add (H) to conductor code for SCH 80 pipe. Example: DPS-62H-BR

Casting: Electrical Bronze

CATALOG NUMBER		CONDUCTOR SIZE (NPS)	THICKNESS (INCHES) T	WEIGHT (POUNDS)
NPS SCH 40	NPS SCH 80			
DPS-39-BR	DPS-39H-BR	1	1/4	0.25
DPS-49-BR	DPS-49H-BR	1-1/4	1/4	0.25
DPS-53-BR	DPS-53H-BR	1-1/2	3/8	0.25
DPS-58-BR	DPS-58H-BR	2	3/8	0.30
DPS-60-BR	DPS-60H-BR	2-1/2	3/8	0.50
DPS-62-BR	DPS-62H-BR	3	3/8	0.50
DPS-63-BR	DPS-63H-BR	3-1/2	3/8	0.60
DPS-64-BR	DPS-64H-BR	4	3/8	0.70
DPS-67-BR	DPS-67H-BR	5	3/8	1.00
DPS-69-BR	DPS-69H-BR	6	3/8	1.40

