

# BRONZE MISCELLANEOUS

## TYPE CFX

Straight Expansion Bend  
Pad to Pad

Copper laminated expansion bend used between bushing terminals and rigid bus. Tinned ends are soldered together under pressure to form one piece unit at contact ends. Pad holes have NEMA spacing. Not recommended as a support member. Pad size & Ampere rating should be specified. Consult manufacturer for further details or unlisted applications.

Material: Copper

CATALOG NUMBER	FIG. NO.	A (INCHES)	AMPS (INDOOR)
CFX-2B-2	1	2	900
CFX-4A-1	2	3	700
CFX-4A-2	2	3	1000
CFX-4A-3	2	3	1200
CFX-4B-2	2	4	1200
CFX-4B-3	2	4	1600
CFX-4B-4	2	4	2000
CFX-4B-6	2	4	3000

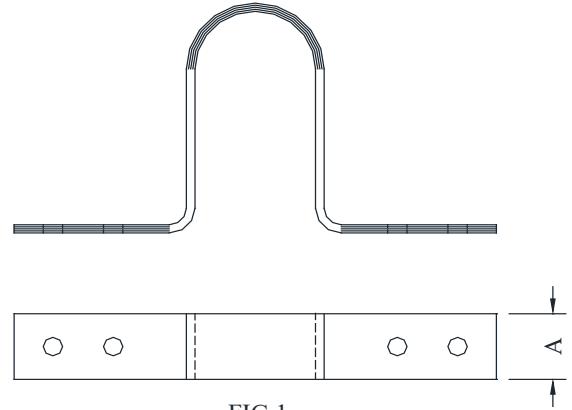

FIG 1

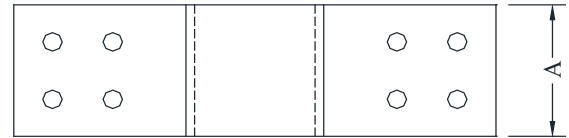

FIG 2

## TYPE CFX90

90° Expansion Bend  
Pad to Pad

Copper laminated expansion bend used between bushing terminals and rigid bus. Tinned ends are soldered together under pressure to form one piece unit at contact ends. Pad holes have NEMA spacing. Not recommended as a support member. Pad size & Ampere rating should be specified. Consult manufacturer for further details or unlisted applications.

Material: Copper

CATALOG NUMBER	FIG. NO.	A (INCHES)	AMPS (INDOOR)
CFX90-2B-2	1	2	800
CFX90-4A-1	2	3	700
CFX90-4A-2	2	3	1000
CFX90-4A-3	2	3	1200
CFX90-4B-2	2	4	1200
CFX90-4B-3	2	4	1600
CFX90-4B-4	2	4	2000
CFX90-4B-6	2	4	3000

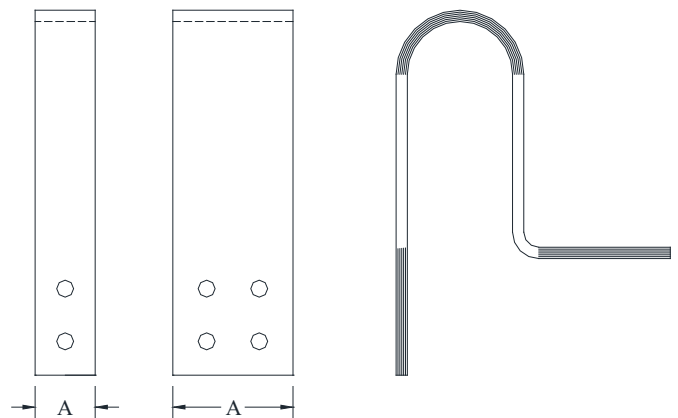

FIG 1

FIG 2