

ALUMINUM MISCELLANEOUS

TYPE APGC

Bolted Cross/Parallel
Cable Run to Cable Tap

Castings: 356-T6 Aluminum
Hardware: Aluminum Alloy

Aluminum bolted parallel or cross connector for connections on aluminum cable. Contact sealant is recommended.
Contact factory for further information.

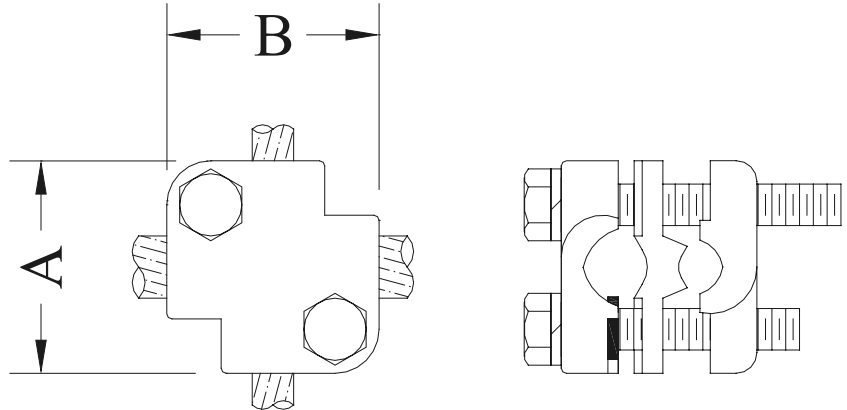

CATALOG NUMBER	CONDUCTOR RANGE		DIMENSIONS - INCHES		WEIGHT (POUNDS)
	MAIN	TAP	A	B	
APGC-1111	#2 - 4/0 AAC	#2 - 4/0 AAC	2-5/8	2-5/8	1.40
APGC-1818	#2 - 397 AAC	#2 - 397 AAC	2-3/4	2-3/4	0.90
APGC-2011	4/0 - 500 AAC	#1 - 250 AAC	2-9/16	2-9/16	0.90
APGC-2916	336 - 795 AAC	1/0 - 336 AAC	2-7/8	2-7/8	1.20
APGC-2929	337 - 795 AAC	397 - 795 AAC	3	3	3.20

TYPE ATP

Bi-Metallic
Transition Plate

Material: 80% Aluminum
20% Copper

Bi-metallic transition plate for making aluminum to copper connections. Total thickness is 1/16".
Contact sealant is recommended.

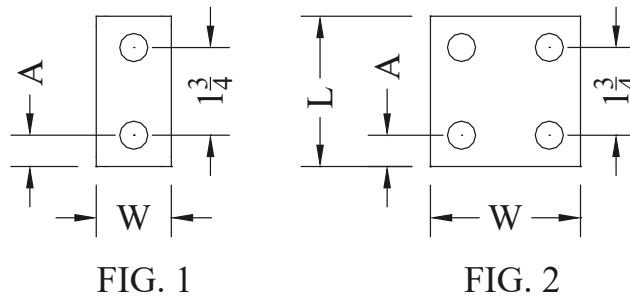

THICKNESS
20% COPPER

THICKNESS
80% ALUMINUM

CATALOG NUMBER	FIG. NO.	DIMENSIONS - INCHES			WEIGHT (POUNDS)
		L	A	W	
ATP-B	1	3	5/8	1-1/2	0.05
ATP-B2	1	3	5/8	2	0.05
ATP-C	2	3	5/8	3	0.10
ATP-D	2	4	1-1/8	4	0.15