

EHV STUD CONNECTORS

TYPE WSXTRHV

Weld Expansion
Stud To Pipe

Castings: 356 Aluminum
Laminated straps: 1100-0 Aluminum
Stud Hardware: Stainless Steel
Connection Hardware: Aluminum
Options: See page 185

Type WSXTRHV is designed for corona-free service at 345 KV. Angle A is factory-set at the required take-off angle (0° - 90°). The value of the required angle is to be inserted within the parenthesis to complete the catalog number.

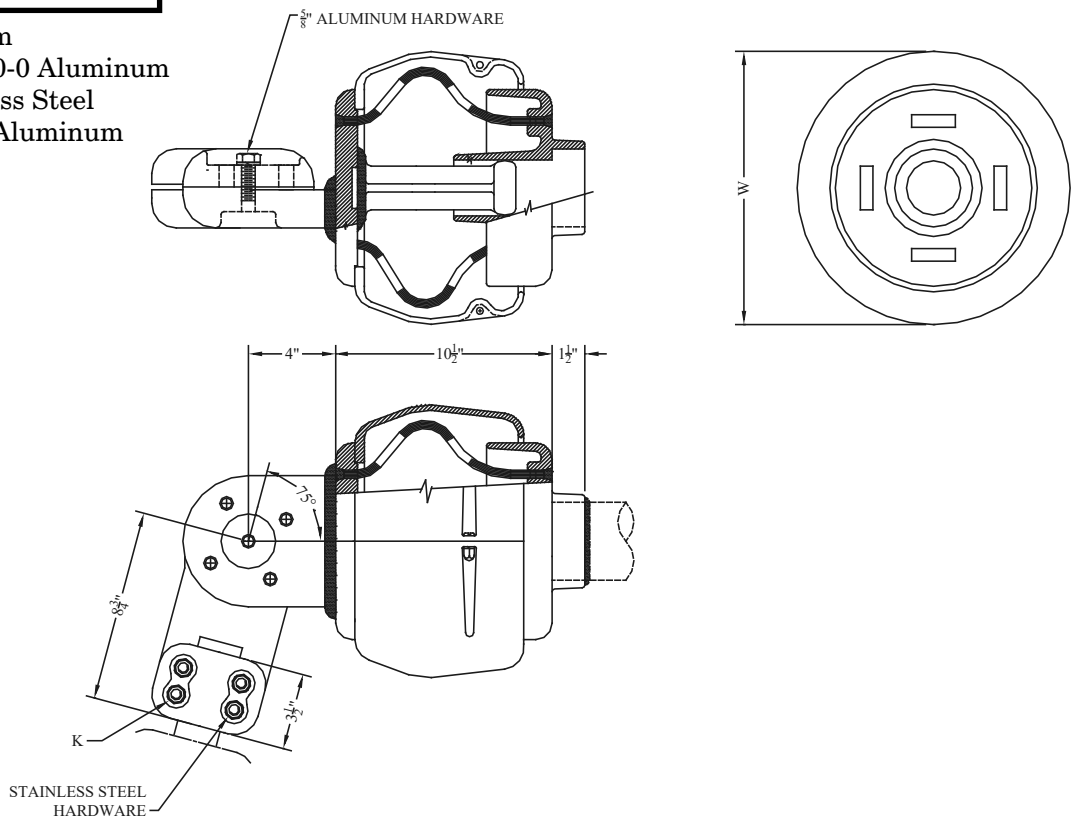

CATALOG NUMBER	STUD DIA./THD.	PIPE SIZE (NPS)	CURRENT CAPACITY	DIMENSIONS-INCHES		WEIGHT (POUNDS)
				W	K	
WSXTRHV-4462-A()	1-1/2 - 12	3	2000 A	12-1/2	1/2	45.20
WSXTRHV-4464-A()		4				39.50
WSXTRHV-5464-A()	2 - 12	4	2000 A	12-1/2	1/2	47.10
WSXTRHV-5467-A()		5				47.10
WSXTRHV-5469-A()		6				47.85
WSXTRHV-5764-A()	2-1/4 - 12	4	2500 A	12-1/2	5/8	44.55
WSXTRHV-5767-A()		5				40.50
WSXTRHV-5964-A()	2-1/2 - 12	4	3000 A	12-1/2	5/8	40.25
WSXTRHV-5967-A()		5				40.75
WSXTRHV-5969-A()		6				41.25
WSXTRHV-6164-A()	3 - 12	4	3000 A	12-1/2	5/8	40.50
WSXTRHV-6167-A()		5				41.00
WSXTRHV-6169-A()		6				41.50
WSXTRHV-6264-A()	3-1/2 - 12	4	3000 A	12-1/2	5/8	40.75
WSXTRHV-6267-A()		5				41.25
WSXTRHV-6269-A()		6				41.75

SEFCOR