

# EHV BUS COUPLERS

ALUMINUM • 345 - 500 KV

## TYPE WLBI-HV

Weld Angle Coupler For Pipe

Castings: 356-T6 Aluminum

Type WLBI-HV angle couplers are designed and factory-finished for corona-free service at the maximum voltages shown. For voltage levels higher than shown in the table it is recommended that large-radius field bends be used. Note: To specify coupler for schedule 80 pipe add "H" to catalog number.

Example: WLBI45-6060H-HV

Also available with other angles. Please contact factory for specifications.

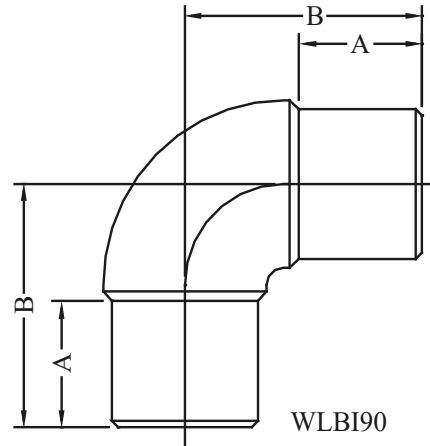
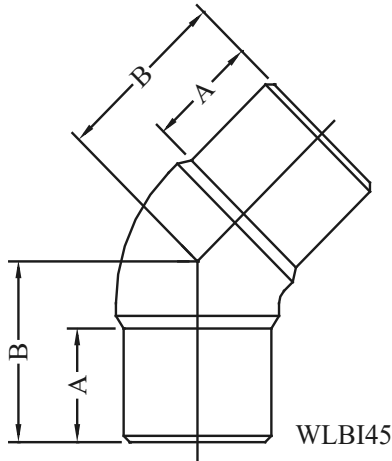

CATALOG NUMBER	PIPE SIZE (NPS)	MAX KV	DIMENSION (INCHES)		WEIGHT (POUNDS)
			A	B	
WLBI45-6060-HV	2-1/2" SCH 40	345	2-3/8	3-3/8	1.00
WLBI45-6060H-HV	2-1/2" SCH 80	345	2-3/8	3-1/2	1.50
WLBI45-6262-HV	3" SCH 40	345	2-7/8	4-5/16	2.25
WLBI45-6262H-HV	3" SCH 80	345	2-7/8	4-5/16	2.25
WLBI45-6363-HV	3-1/2" SCH 40	345	2-7/8	4-5/16	2.50
WLBI45-6363H-HV	3-1/2" SCH 80	345	2-3/4	4-7/16	3.25
WLBI45-6464-HV	4" SCH 40	500	2-3/4	4-1/2	3.35
WLBI45-6464H-HV	4" SCH 80	500	2-5/8	4-1/2	3.50
WLBI45-6767-HV	5" SCH 40	500	4-1/2	6-3/8	8.50
WLBI45-6767H-HV	5" SCH 80	500	4-1/2	6-3/8	8.50
WLBI45-6969-HV	6" SCH 40	500	4-1/2	7	10.25
WLBI45-6969H-HV	6" SCH 80	500	5-1/8	7	12.00
WLBI90-6060-HV	2-1/2" SCH 40	345	2-1/2	4-7/16	2.00
WLBI90-6060H-HV	2-1/2" SCH 80	345	2-3/8	4-9/16	1.75
WLBI90-6262-HV	3" SCH 40	345	2-7/8	5-5/8	3.50
WLBI90-6262H-HV	3" SCH 80	345	2-7/8	5-5/8	2.75
WLBI90-6363-HV	3-1/2" SCH 40	345	2-3/4	6-1/8	4.25
WLBI90-6363H-HV	3-1/2" SCH 80	345	2-3/4	6-3/16	4.75
WLBI90-6464-HV	4" SCH 40	500	2-5/8	6-1/4	4.15
WLBI90-6464H-HV	4" SCH 80	500	2-5/8	6-3/8	4.75
WLBI90-6767-HV	5" SCH 40	500	4-11/16	8-5/8	10.00
WLBI90-6767H-HV	5" SCH 80	500	4-5/8	8-5/8	9.25
WLBI90-6969-HV	6" SCH 40	500	5	9-5/8	14.00
WLBI90-6969H-HV	6" SCH 80	500	5	9-1/2	12.75