

ALUMINUM BUS SUPPORTS

TYPE AVCA

Horizontal Bolted
One Cable to Insulator

Aluminum alloy bus support for aluminum cable. Hex-stops provided for one-wrench installation of clamping bolts.

Hardware supplied for CAP mounting. For PIN mounting, add suffix (P) to catalog number.

Example: AVCA-24-3P

Castings: 356-T6 Aluminum

Clamping Hardware: Aluminum

Mounting Hardware: Galvanized Steel

* AVCA-1139 Bus Support

will also accept a range of pipe 1/4"-1" N.P.S.

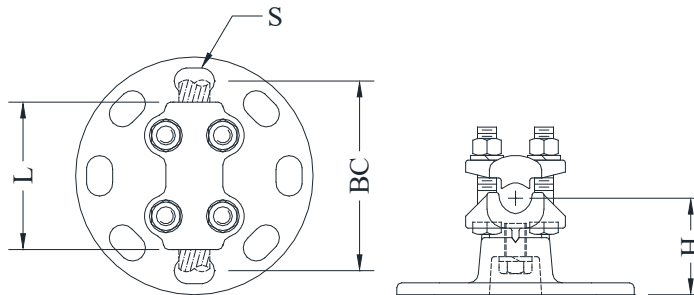

CATALOG NUMBER	CONDUCTOR RANGE		DIMENSIONS - INCHES				WEIGHT (POUNDS)
	AAC	ACSR	H	L	B.C.	S	
AVCA-13-3	#4-266 MCM	#4-4/0	1-3/4	3	3	9/16 x 13/16	1.90
AVCA-13-5			1-13/16	3	5	11/16 x 1	2.65
AVCA-20-3	4/0-500 MCM	4/0-397.5 MCM	2-5/8	3 1/2	3	9/16 x 13/16	2.30
AVCA-20-5			2-7/8	3 1/2	5	11/16 x 1	3.15
AVCA-24-3	350-650 MCM	336-556 MCM	2-7/8	4	3	9/16 x 13/16	2.30
AVCA-24-5			2-7/8	4	5	11/16 x 1	3.15
AVCA-34-3	500-1000 MCM	477-795 MCM	3-1/8	4	3	9/16 x 13/16	2.60
AVCA-34-5			3-1/8	4	5	11/16 x 1-1/16	3.50
AVCA-39-3	874-1272 MCM	715-1113 MCM	3-1/8	4 1/4	3	9/16 x 13/16	2.85
AVCA-39-5			3-3/8	4 1/4	5	11/16 x 1-1/16	3.80
AVCA-43-3	1250-1590 MCM	1113-1431 MCM	3-1/4	4 1/2	3	9/16 x 13/16	3.70
AVCA-43-5			3-3/8	4 1/2	5	11/16 x 1	4.60
AVCA-46-3	1250-1800 MCM	1113-1590 MCM	3-1/8	4 3/4	3	9/16 x 13/16	3.75
AVCA-46-5			3-3/8	4 3/4	5	11/16 x 1-1/16	4.60
AVCA-51-3	1500-2250 MCM	1351-2156 MCM	3-3/8	5	3	9/16 x 13/16	4.25
AVCA-51-5			3-3/8	5	5	11/16 x 1-1/16	5.10
AVCA-52-3	2500 MCM	-----	3-1/2	3 1/8	3	9/16 x 13/16	2.90
AVCA-52-5			3-7/16	3 1/8	5	11/16 x 1-1/16	3.80
AVCA-1020-3	#1 - 500 MCM	#2 - 397.5 MCM	2-5/8	3-1/2	3	9/16 x 13/16	2.30
AVCA-1020-5			2-15/16	3-1/2	5	11/16 x 1	3.10
AVCA-1139-3	4/0-1300 MCM	4/0-1113 MCM	3-3/8	4 1/4	3	9/16 x 13/16	3.20
AVCA-1139-5			3-3/8	4 1/4	5	11/16 x 1	4.05
AVCA-2743-3	750-1590 MCM	605-1431 MCM	3-1/4	4 1/4	3	9/16 x 13/16	3.70
AVCA-2743-5			3-1/2	4 1/2	5	11/16 x 1	4.55
AVCA-3653-3	CONTACT FACTORY FOR DETAILS						
AVCA-3653-5							