

ALUMINUM MISCELLANEOUS

TYPE APGC

Bolted Cross/Parallel
Cable Run to Cable Tap

Aluminum bolted parallel or cross connector for connections on aluminum cable.
Contact sealant is recommended.
Consult manufacturer for further details or unlisted applications.

Casting Alloy: 356-T6 Aluminum
Clamping Hardware: Aluminum Alloy

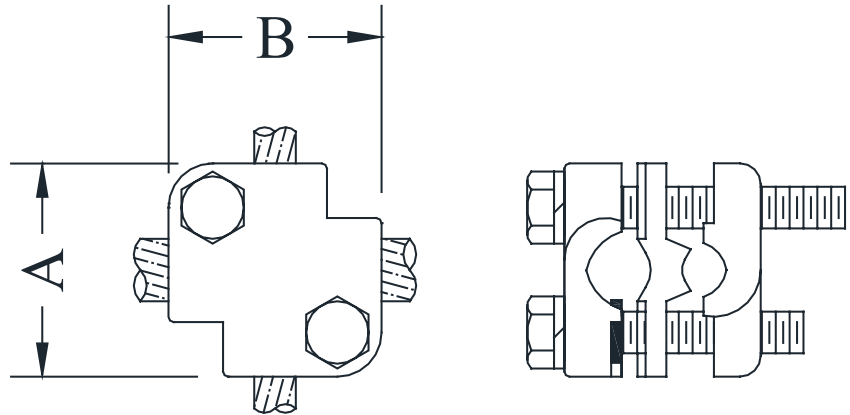

CATALOG NUMBER	CONDUCTOR RANGE		DIMENSIONS - INCHES		WEIGHT (POUNDS)
	MAIN	TAP	A	B	
APGC-1111	#2 - 4/0 AAC	#2 - 4/0 AAC	2-5/8	2-5/8	1.40
APGC-1818	#2 - 397 AAC	#2 - 397 AAC	2-3/4	2-3/4	0.90
APGC-2011	4/0 - 500 AAC	#1 - 250 AAC	2-9/16	2-9/16	0.90
APGC-2916	336 - 795 AAC	1/0 - 336 AAC	2-7/8	2-7/8	1.20
APGC-2929	397 - 795 AAC	397 - 795 AAC	3	3	3.20

TYPE ATP

Bimetallic
Transition Plate

Bimetallic transition plate for making aluminum to copper connections.
Total thickness is 1/16".
Contact sealant is recommended.

Material: 80% Aluminum
20% Copper

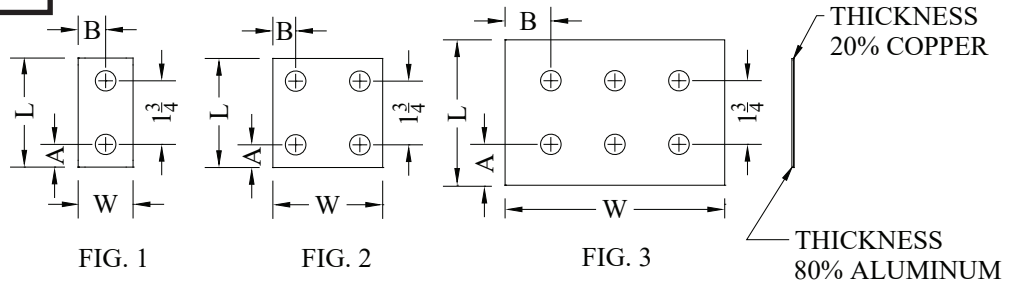

CATALOG NUMBER	FIG. NO.	DIMENSIONS - INCHES				WEIGHT (POUNDS)
		L	A	B	W	
ATP-B	1	3	5/8	3/4	1-1/2	0.05
ATP-B2	1	3	5/8	1	2	0.05
ATP-C	2	3	5/8	5/8	3	0.10
ATP-D	2	4	1-1/8	1-1/8	4	0.15
ATP-6A	3	4	1-1/8	3/4	5	0.17
ATP-6B	3	4	1-1/8	1-1/4	6	0.20